

“How Do I Change the Leg Orthoses with LokomatPro V6 FreeD Kombi?”

To perform a Lokomat session with a pediatric patient or with a patient whose femur length is shorter than 35 cm, you need to install the pediatric leg orthoses. The two sets of orthoses (adult or pediatric) can easily be exchanged by the therapist in only a few minutes.

Changing the leg orthoses

1. Go to the main menu.

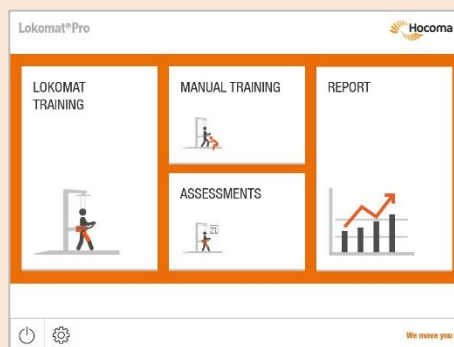

2. Open the swivel door.
3. Bring the gait orthosis down and lock with the strap provided.

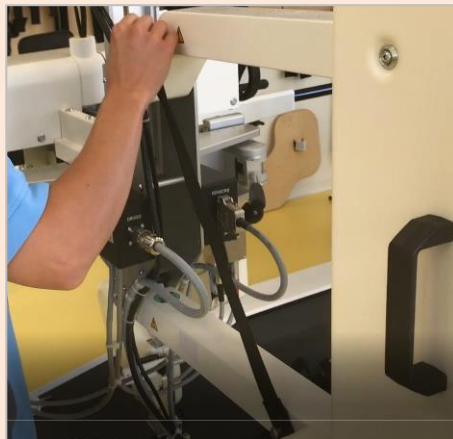

4. Bring the pelvic depth to its maximum forward position.
5. Remove the two cables behind the orthosis, pulling them straight down, without twisting.



6. Unloop the black strap from the pin.

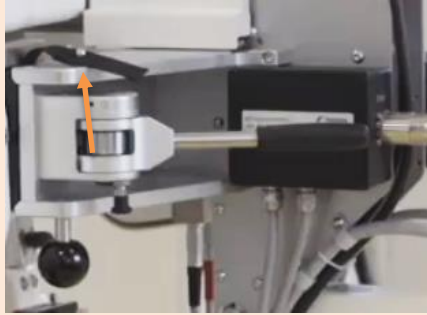

7. Open the clamping lever by pulling the locking pin down and by swinging the lever out until locking pin clicks back into place.

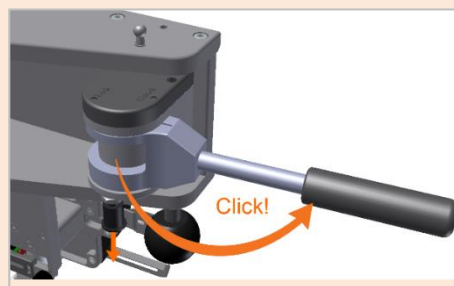

8. Remove the adult leg orthosis by sliding it out laterally.



9. Take the same sided pediatric leg orthosis and slide it onto the mounting bracket all the way.



10. Pull the locking pin and swing the clamping lever back inward until it clicks. Now it is locked into place.

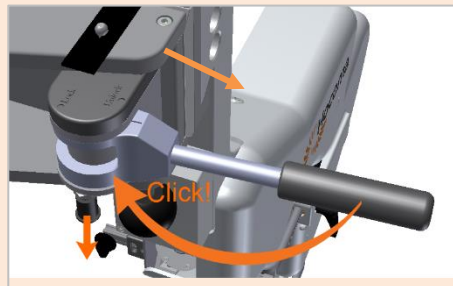

11. Loop the strap on to the pin as an added safety measure.



12. Reconnect the cables to their respectively colored plugs (red cable with red indicator and black cable with black indicator) on the terminal box behind the orthosis.



13. Repeat the same steps for the other leg.
14. After changing out the leg orthoses, you will need to exchange the pelvic interface. Remove the adult pelvic orthosis by loosening the locking screw behind it.



15. Attach the hip fixation extension plate and tighten the locking screw.

